

### SPECIAL FEATURES

- FIXED POINTER & MOVABLE DIAL
- SOCKET & CASE WELDED
- RUGGED CONSTRUCTION FOR CORROSIVE & VIBRATION SERVICE
- RANGE FROM 40 kg/cm<sup>2</sup> to 800 kg/cm<sup>2</sup>

### APPLICATIONS

MUD PUMP, STAND PIPE MUD PUMP, PETROLEUM, WELL DRILLING.

### SPECIFICATIONS

#### STANDARD VERSION : 100 mm

<b>Accuracy</b>	: ±2% of F. S.
<b>Dial material &amp; colour</b>	: Aluminium stove enamelled white
<b>Dial marking</b>	: Black on White Background
<b>Case Filling</b>	: Glycerine Filled
<b>Case &amp; Ring</b>	: Gun metal casting, Weather proof gray Hammertonefinish
<b>Bourdon</b>	: AISI 316 SS
<b>Movement</b>	: AISI 304 SS
<b>Window</b>	: Perspex
<b>Mounting &amp; Entry</b>	: Direct with bottom
<b>Sensing element</b>	: AISI 316L SS Diaphragm
<b>Chamber Material</b>	: Stainless steel
<b>Sealing fluid</b>	: Silicon oil
<b>Mud protection</b>	: Neoprene rubber pad
<b>Process connection</b>	: 2" NPT (M)
<b>Process conn.Material</b>	: Mild steel, anti-corrosion treated

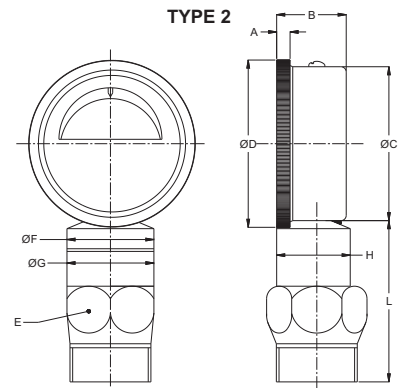

A	B	ØC	ØD	E	ØF	ØG	H	L	Weight in gram (With Box)
10	51	115	125	65	65	65	55	121	3460.0

Note: Drawings are not to scale. All dimensions are in mm.

#### Temperature effect:

The variation of indication caused by effects of temperature is to be calculated by below formula; which is to be added in the specified accuracy while measurement :-  
Formula : ± 0.08 x (t2 - t1) % of F. S.  
where t1 = reference temperature (+20°C) and t2 = ambient temperature in °C.

### HOW TO ORDER

#### BASIC MODEL

#### CODE

#### NOMINAL SIZE

F  
100 mm

#### TYPE OF MOUNTING

2 DIRECT BOTTOM ENTRY

#### GAUGE CONNECTION

9BM 1½" BSP (M) JA 2" BSP (M) 9NM 1½" NPT (M) JS 2" NPT (M)

#### RANGE (bar or kg/cm<sup>2</sup>)

0/40 0/60 0/100 0/160 0/250 0/400 0/600 0/800

\* kindly mention pressure unit while ordering

Ordering Example: **BM - X - X - XX OR XXX - 0/250**

FOR OTHER OPTIONAL ITEMS, PLEASE CONTACT FACTORY FOR DELIVERY AND MINIMUM QUANTITY OF ORDER.

Note : Specifications and dimensions given in this product catalogue represents the state of engineering at the time of printing.

Modifications may take place and materials specified may be replaced by others without prior notice.

Notes : • Drawings are not to scale. • All Dimensions are in mm

Example

**BM**

**X**

**X**

**XX OR**

**XXX**

**0/250**